



TALON TIGHT

FUEL TANK LOCK

HOW TO MEASURE FUEL TANK FILLER NECK

Measuring the outside diameter:

Measure, in inches, the fuel tank filler neck opening

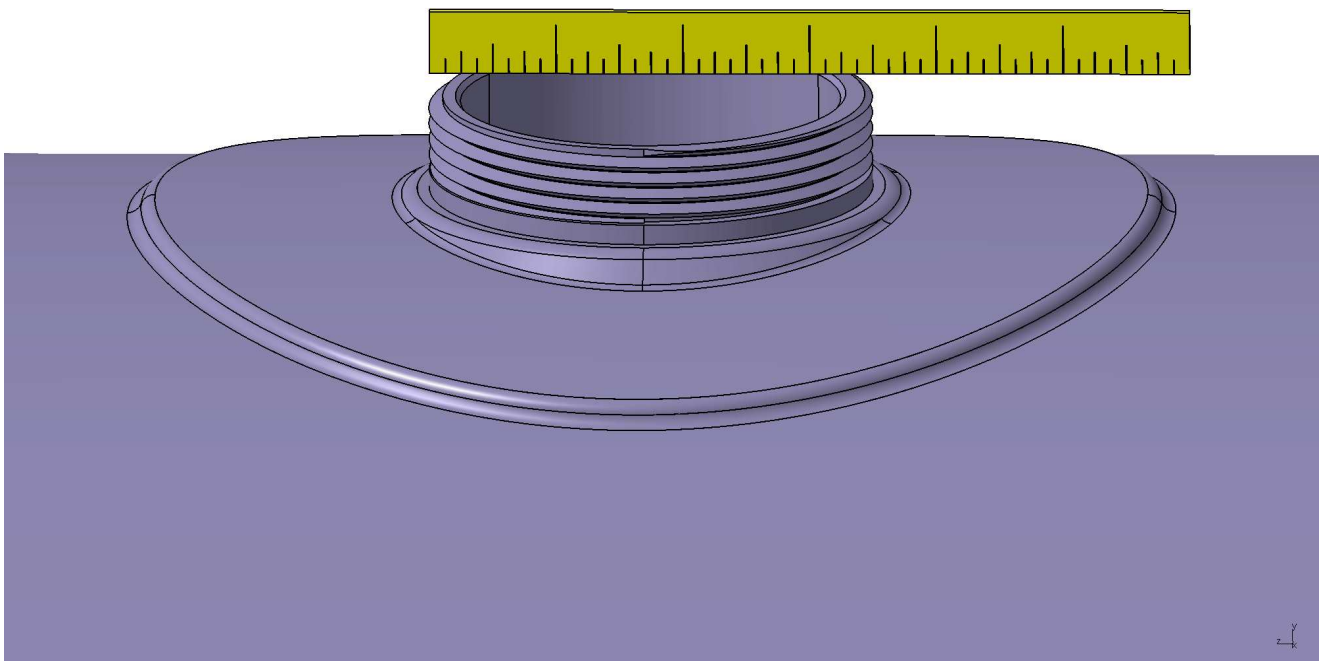

1795, Boulevard Industriel
Magog, Québec
Canada
J1X 5P2

ROBOND

Téléphone : 819-847-3133
Fax : 819-847-3469
Courriel : sales@robond.com
Site Internet : www.robond.com

Number of threads:

To calculate the number of threads per inch, take a ruler and starting at the top of a thread, count the number of tips over a 1/2 inch area and multiply by 2.

Example: 4 tips over a 1/2 inch area x 2 = 8 threads per inch.

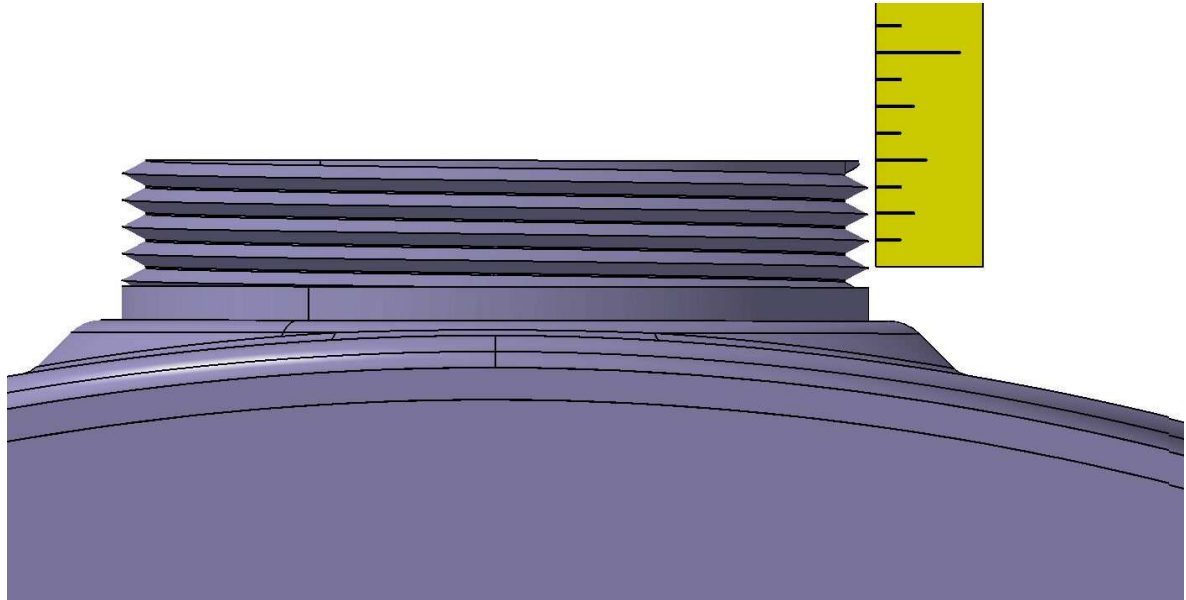

Length of the pipe:

This information is important for the Fuel Tank Lock models CL-300 and CL-600 because the locking system is based on the length of the pipe. You must measure the full length of the pipe, from the inside to the top of the tank filler neck opening.

Your measurement should not exceed 3 5/8'' long (92 mm) for CL-300 and CL-600

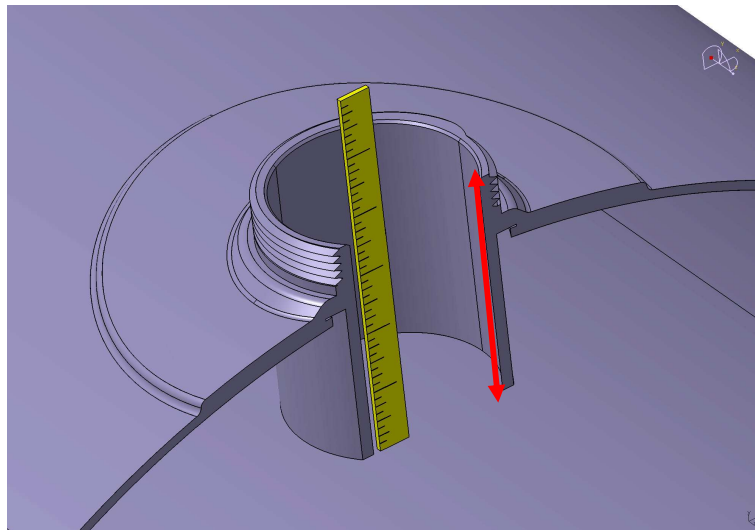

For more information, do not hesitate to [contact](#) us.

ROBOND

1795, Boulevard Industriel
Magog, Québec
Canada
J1X 5P2

Téléphone : 819-847-3133
Fax : 819-847-3469
Courriel : sales@robond.com
Site Internet : www.robond.com